

The iPad Curve is our entry level free standing unit and enclosure designed for quick and easy utilisation where power may not be available. As with all our iPad products where simple fast delivery of messages are key to your communication they are an ideal solution, designed to be versatile and practical whilst safely securing your iPads.

Features & Benefits

- Durable silver grey painted steel enclosure and matching floor stand
- iPad powered from inbuilt battery or via charging port access
- Black high gloss acrylic fascia
- Push button security lock with key release
- Versatile enclosure over tilts through 120° and fully rotates 360°
- Optional Enclosure Lock & Cable (Security Cord) with two keys

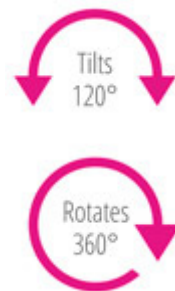
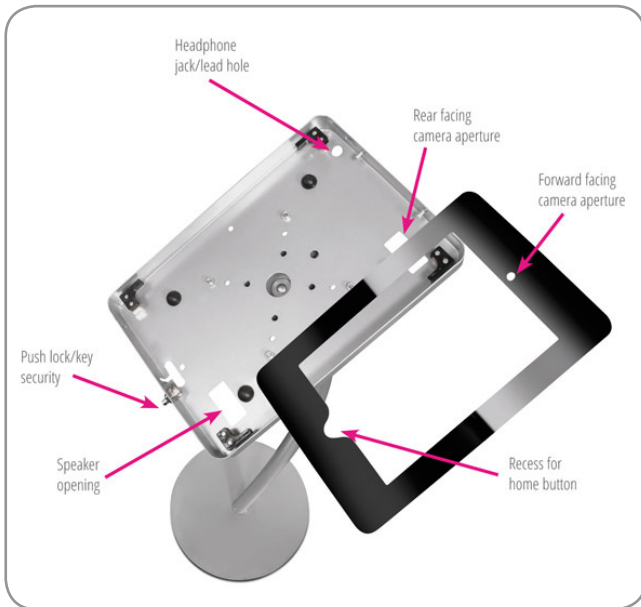

Hardware Specifications	Graphic Specifications	Additional Information
<p>Maximum Overall Dimensions: 370mm diameter x 1210mm(h)</p> <p>Weight: 9.2kg</p>	N/A	<p>Additional features: Holds iPad 2, 3, 4 Home button recess allowing Guided Access on iOS 6 and above</p>

Assembly instructions



1

WARNING – base plate is heavy.
Carefully position base plate over bottom of curved upright and align central fixing hole to thread of post (ensuring the countersunk hole is uppermost). Insert and tighten large base plate screw to secure.

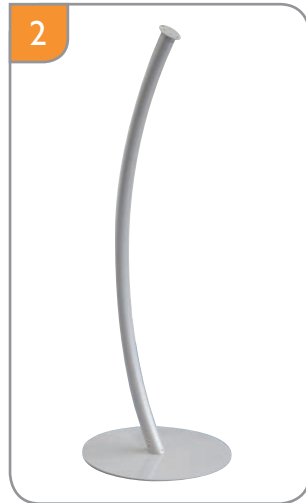

2

Carefully stand base and post assembly upright.



3

Align 2 holes of plate behind iPad holder to threads of the curved post plate. Insert and tighten screws to secure.



4

Unlock the iPad enclosure by inserting key into security lock and rotate 'QUARTER TURN ONLY' clockwise or counter-clockwise through 90 degrees which releases the locking pin. Return key back to original position to remove. Lift fascia out of enclosure, place iPad inside, gently press all four corners down into mouldings to hold.



5

Replace fascia and depress lock button to secure enclosure.